

# Mynute S

Standard-efficiency Wall-Hung Boilers

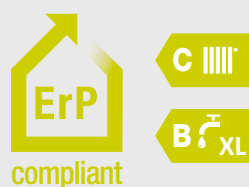

Residential Heating





## A good value for money boiler, specific for replacement

### QUICK AND EASY TO INSTALL, FOR A PERFECT REPLACEMENT

Mynute S is particularly easy to install and is specifically designed for a trouble-free replacement of older standard-efficiency boilers.

### LOW ENERGY SYNCHRONOUS PUMP

Reduction of the electrical consumption, thanks to the new Low Energy synchronous pump ( $EEL \leq 0,20$ ), in compliance with the ErP regulations.

### A GOOD VALUE FOR MONEY, RELIABLE BOILER

Mynute S is a good value for money boiler, featuring double heat exchanger, the most innovative safety devices and high solidity of the boiler structure.

## MYNUTE S range is ErP compliant

Beretta MYNUTE S range complies with the European ErP regulations, which came into force on 26.09.2015.

From that date onwards, a new energy labelling was implemented for appliances and systems producing heating and domestic hot water and a series of efficiency and emissions constraints automatically excluded the less performing classes of appliances. The new ErP regulations aim to help the EU countries to reach by 2020 the “20-20-20” target, meaning a 20% reduction of gas emissions; a 20% increase in the use of renewable energies; a 20% reduction in global energy consumptions.



CO<sub>2</sub> reduction



renewable  
energies



energy  
consumptions



### Space heating function

Seasonal space heating  
energy efficiency class:  
C (on all models)

### Water heating function

This section refers only to  
combi models:

- Load profile: XL
- Energy Efficiency Class: B

### Sound power level indoors

Specifications for each  
model are detailed on  
the back cover page

### Rated heat output

Specifications for each  
model are detailed on  
the back cover page

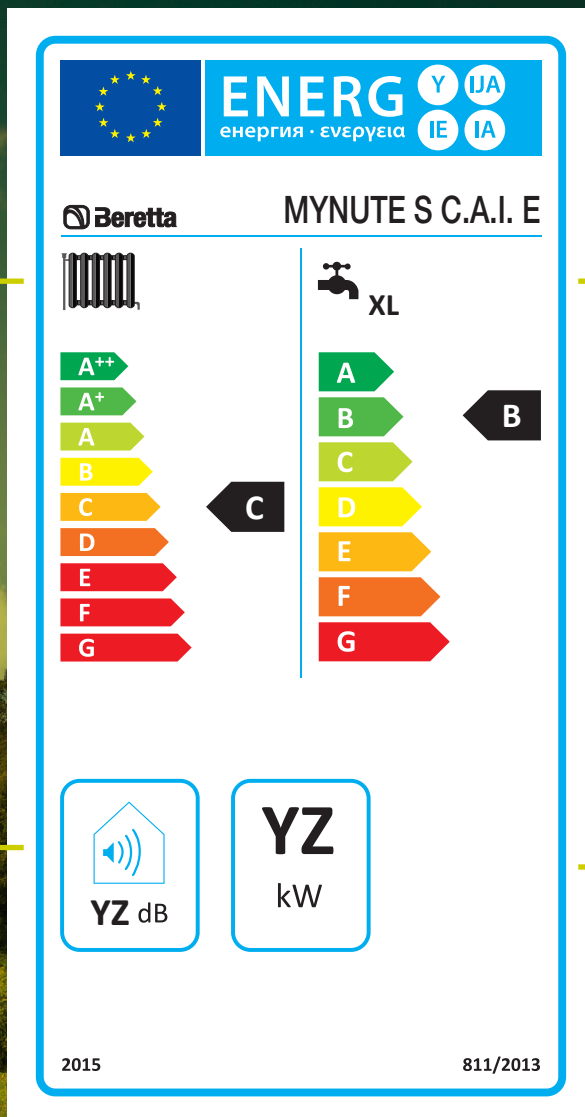

## Saving energy, saving money

The new energy labelling, that according to the ErP directive was implemented in September 2015 for appliances and systems producing heating and domestic hot water, means that all boilers and heating systems are labelled in the same way as “white goods”, like washing machines and refrigerators. The energy labelling enables the end-users to make realistic comparisons among different products. By choosing high efficiency products, the end-users can lower their energy bills, helping to safeguard the environment.



# Mynute S



MYNUTE S range fully complies with the European ErP regulations:



seasonal space heating energy efficiency class



water heating energy efficiency class and water heating load profile

- The new MYNUTE S has been specifically designed for a trouble-free installation, especially in case of replacement.
- Primary heat exchanger in copper.
- DHW plate heat exchanger in stainless steel.
- LOW ENERGY, synchronous pump (EEI≤0,20) 6 metres, with anti-blocking function.
- Intuitive and easy-to-use control panel with backlight digital display.
- Built-in climatic thermoregulation that can be activated through the external probe (as option) for a high comfort level inside the house.

- S.A.R.A. system: automatic temperature control in heating mode.
- IPX5D electrical protection.
- Double air inlet (right and left side) allowing to fit easily in the existing flues.
- 9 litres expansion vessel, able to manage installations with high water content.
- "Survivor" function in DHW mode, allowing the boiler, in the event of failure of the DHW NTC probe, to continue to operate.
- Compact dimensions and low weight allow MYNUTE S to be installed anywhere.
- MYNUTE S models are available also as LPG versions: 24 C.A.I. E with a dedicated model; 28 C.A.I. E through a specific LPG transformation kit (as option).
- Hydraulic connections, gas and DHW taps (available as option) for easier installation.



Flame detector



Electrical protection IPX5D



"Survivor" function



Circulator anti-blocking cycles



Frost protection system

Hinged flap for control panel protection

Hydrometer



## A simple and modern style

The new MYNUTE S is characterized by a simple and modern design. The control panel, located under a neat hinged flap, is particularly easy-to-use. The simple and intuitive backlight digital display makes all information about boiler status immediately available.

The two ergonomic selectors allow to easily activate all boiler functions.

On/Off/Summer/Winter/  
Reset/Heating temperature/  
"S.A.R.A. function"  
selector

Domestic hot water  
temperature selector/  
Pre-heating activation  
selector



## Technology and reliability

The new MYNUTE S offers highly reliable combustion and electronics and boasts the high electric protection degree IPX5D.

Thanks to the high quality components, the range is characterized by safety and solidity.

MYNUTE S comes with the most innovative safety devices: control systems that check the flame presence, the proper exhaust flue evacuation, the temperatures and pressures. The anti-blocking function on the pump and the frost protection system on

the electronic board increase boiler longevity.

The new MYNUTE S also boasts the "Survivor" Function in DHW mode, allowing the boiler, in the event of failure of the NTC probe, to continue operating.

- 1 Filling tap
- 2 Water pressure switch
- 3 Drain tap
- 4 3-way valve
- 5 Circulation pump
- 6 Air vent valve
- 7 Flame ignition-detection electrode
- 8 Burner
- 9 Limit thermostat
- 10 Primary NTC probe
- 11a Fumes thermostat (24 kW)
- 11b Fumes thermostat (28 kW)
- 12 Heat exchanger
- 13 Expansion tank
- 14 Domestic hot water NTC probe
- 15 Gas valve
- 16 Safety valve
- 17 Flow switch
- 18 Domestic hot water exchanger

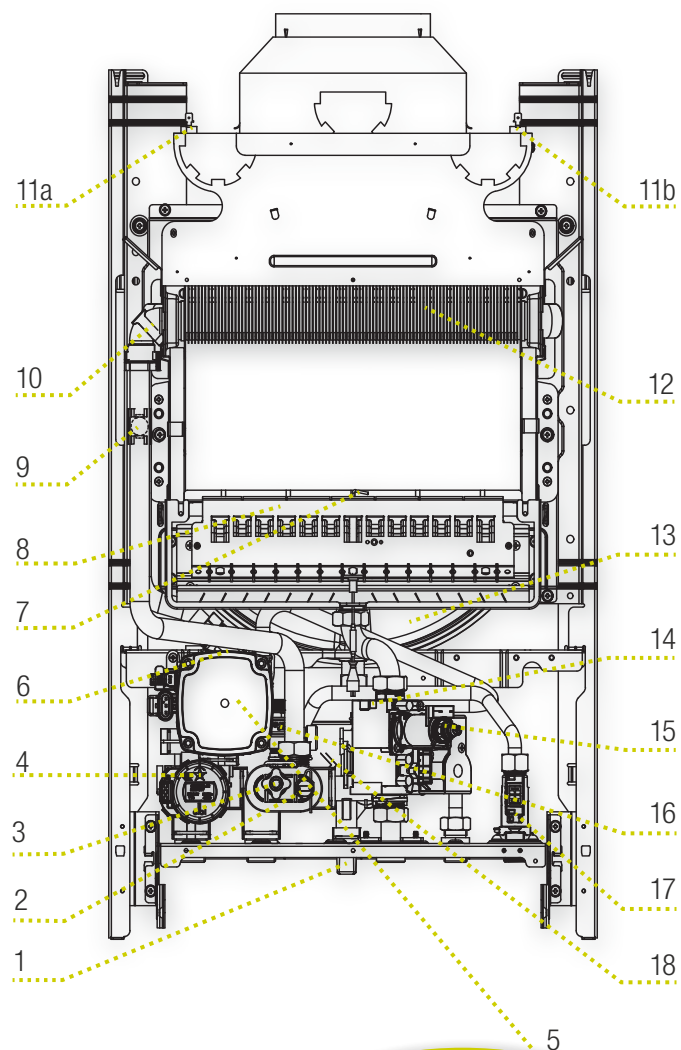

## Low Energy pump: optimized efficiency, low consumption

Mynute S features a new Low Energy synchronous pump, complying with the ErP Directive.

Thanks to this new technology, the electric motor of the pump offers an Energy Efficiency Index lower than 0,20, meaning dramatically reduced electrical consumption.





# Mynute S

## S.A.R.A. system: comfort and saving

MYNUTE S models are equipped with the Beretta patented S.A.R.A. system (Automatic Temperature Control), which can be enabled by moving the temperature control knob of the central heating circuit to the "AUTO" sector (between 55°C and 65°C).

The S.A.R.A. system achieves the best compromise between the average temperature of the radiators and the quickness in reaching the required room temperature, while **providing energy and money saving**.

When there is a demand for heating, the appliance will automatically raise the heating flow temperature twice by 5°C every 20 minutes, in order **to heat the home more quickly**.

When the heating request has been satisfied, the appliance will switch off automatically till the next heating request. At that point the boiler will start again at the previously set flow temperature.

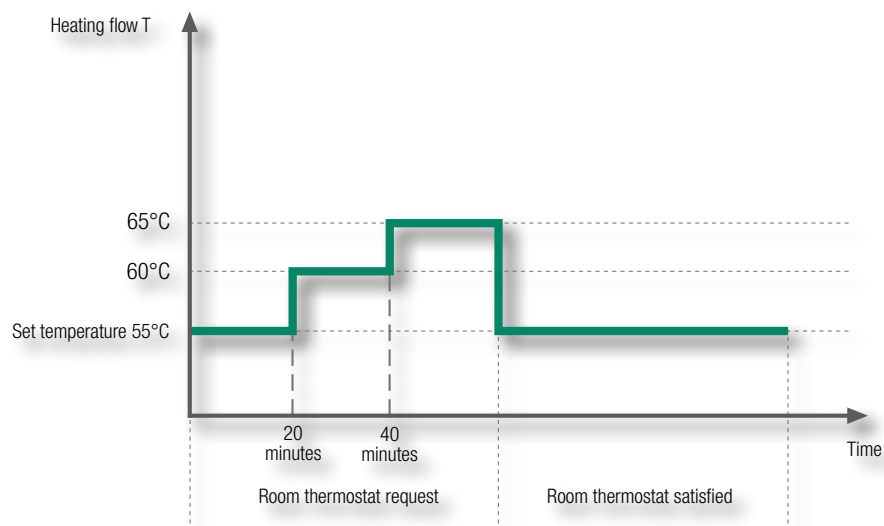

## BeSMART, a new way to manage your boiler from wherever you are



Mynute S can be connected with the new BeSMART WiFi programmable thermostat developed by Beretta, allowing maximum comfort and savings. BeSMART, characterized by a simple and elegant design, fitting easily into any setting, allows to control the home comfort from wherever you are, **via Smartphone or Tablet**. Through the

**BeSMART App** you can easily program and control your heating system in a very simple way. Furthermore, Mynute S allows to enjoy the TOP advantages offered by BeSMART only to Beretta boilers of latest generation, featuring **OTBus connection**. With BeSMART and Mynute S you will have a greater degree of connectivity, view your

boiler's operating conditions, alerts, parameters, home and outdoor temperature and much more. You can even reset your boiler when needed. All this from a simple App. BeSMART can also work as a traditional programmable room thermostat. For further information visit the web site **besmart-home.com**.



Technical drawings

KEY:  
System: Return R/Flow F/Gas G  
Domestic water: Outlet O/Inlet I

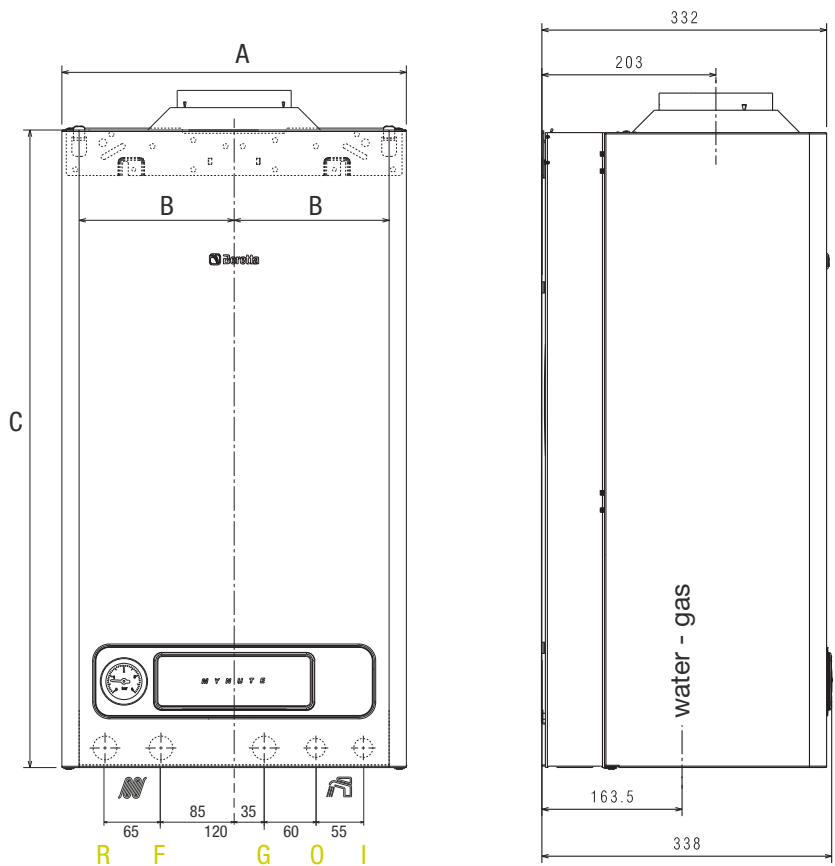

	A	B	C	Weight
24 C.A.I.	400	180	740	30
28 C.A.I.	450	205	740	32

MINUTE S 24 C.A.I. E

MINUTE S 28 C.A.I. E

View from above

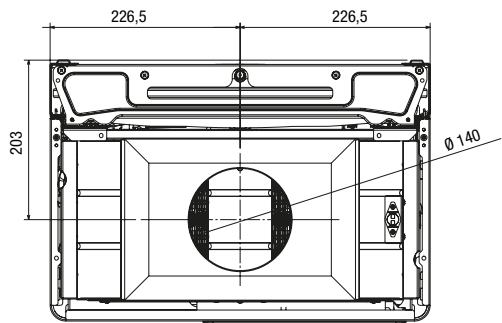
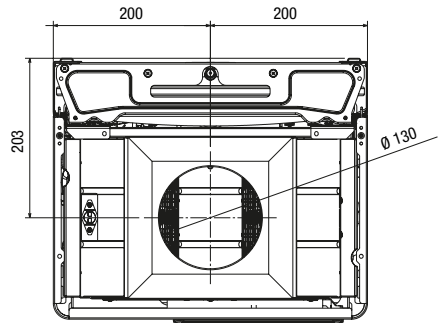

View of hydraulic connection

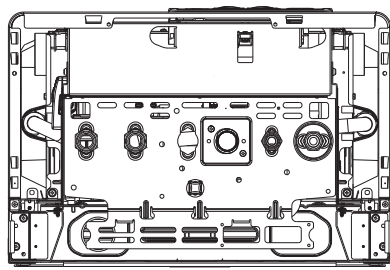
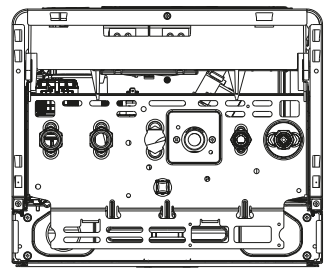



# Technical data

**C** Combi model (CH + DHW)

**A** Conventional flue

**I** Ionisation flame control



## ENERGY LABELLING SPECIFICATIONS (according to ErP regulations)

MYNUTE S  
24 C.A.I. E

MYNUTE S  
28 C.A.I. E

Seasonal space heating energy efficiency class		C	C
Water heating energy efficiency class		B	B
Declared load profile		XL	XL
Rated heat output	kW	24	29
Sound power level inside	dB	54	53
Seasonal space heating energy efficiency	%	77	77

## AUXILIARY ELECTRICITY CONSUMPTION

At full load	W	16,0	14,0
At part load	W	6,4	6,3
In Stand-by mode	W	2,3	3,0

## OTHER SPECIFICATIONS

CH nominal heat input	kW	26,70	31,90
CH nominal heat output (80°-60° C)	kW	23,98	28,71
CH minimum heat input	kW	10,70	14,00
CH minimum heat output (80°-60° C)	kW	9,14	11,93
DHW nominal input	kW	26,70	31,90
DHW maximum output*	kW	23,98	28,71
DHW minimum input	kW	8,30	8,70
DHW minimum output*	kW	7,09	7,41
Efficiency at max - min nominal output (80°-60° C)	%	89,8 - 85,4	90,0 - 85,2
Efficiency at partial load 30% (30°C return)	%	-	-
Efficiency at partial load 30% (47°C return)	%	89,5	89,5
NOx class		2	2
Max power consumption CH // DHW	W	56 // 56	54 // 54
Electrical protection	IP	X5D	X5D

## CENTRAL HEATING

Maximum pressure - temperature	bar - °C	3 - 90	3 - 90
--------------------------------	----------	--------	--------

## DHW

Maximum - minimum pressure	bar	6 - 0,15	6 - 0,15
DHW production ΔT=25°C // 30°C // 35°C	l/min	13,7 // 11,5 // 9,8	16,5 // 13,7 // 11,8
Adjustable hot water temperature range	°C	37/60	37/60

## CONNECTIONS

CH flow - return / Gas	Ø	3/4"	3/4"
DHW inlet - outlet	Ø	1/2"	1/2"

## FLUE PIPES

Diameter	mm	130	140
----------	----	-----	-----

## GAS

Certified gas types		II2H3+ // II2HM3+// II2HM3B/P // II2ELwLs3P // II2ELwLs3B/P	
Available gas versions		NG/LPG	NG/LPG**

\* average among the different functioning conditions in DHW

\*\* LPG version available with conversion kit (supplied as option)

Trading Address:  
Via Risorgimento, 23/A  
23900 LECCO (LC)  
Italy  
Tel. +39 0341 277111  
Fax +39 0341 277263  
info@berettaboilers.com  
www.berettaboilers.com

In order to improve its products, Beretta reserves the right to modify the characteristics and information shown in this brochure at any time and without advance warning.  
This brochure, therefore, cannot be considered as contractually binding on third parties.

