

- The new CIAO S, available in room-sealed version of 24kW outputs, is characterized by reliability and robustness.
- Primary heat exchanger in copper.
- DHW plate heat exchanger in stainless steel.
- Efficiency ★★★ according to European Directive EEC 92/42.
- Double air inlet (right and left side) allowing to fit easily in the existing flues.
- 8 litres expansion vessel.
- Suitable for connection with Beretta remote control panels (optional).
- 3-speed circulator 5 metres.
- “Survivor” function in DHW mode, allowing the boiler, in the event of failure of the DHW NTC probe, to continue to operate.
- Intuitive and easy-to-use control panel with backlight digital display.
- Built-in climatic thermoregulation that can be activated through the external probe (as option) for a high comfort level inside the house.
- S.A.R.A. system: automatic temperature control in heating mode.
- IPX5D electrical protection.
- Frost protection down to -10 °C by using the specific kit available as option.
- Upper and lower covers available as option.
- Fast and easy installation (template and accessories for the installation supplied as standard).
- Hydraulic connections, gas and DHW taps available as option.
- Extremely compact dimensions and low weight allow CIAO S to be installed anywhere.

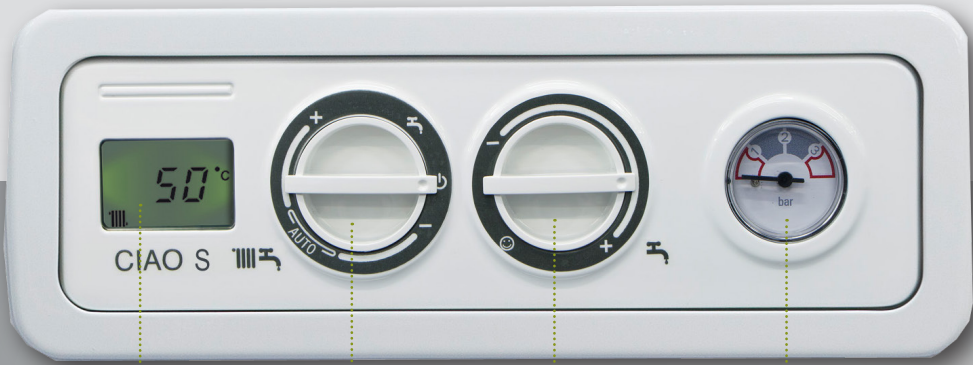

Simple and easy-to-use

The new CIAO S, thanks to the simple design, blends easily into any setting. The intuitive digital display provides the end-user immediately with all information about the boiler status. Two user-friendly selectors allow to easily control all the boiler functions.

- 1 Backlight digital display
- 2 On/Off/Summer/Winter/Reset/Heating temperature/“S.A.R.A. function” selector
- 3 Domestic hot water temperature/ Pre-heating activation selector
- 4 Hydrometer

A range designed to provide high performance



The new CIAO S is equipped with two heat exchangers: primary heat exchanger in copper and DHW plate heat exchanger, ensuring high DHW comfort.

- 1 Double air inlet for twin system
- 2 Flue gas analysis
- 3 Expansion vessel
- 4 Gas valve
- 5 DHW heat-exchanger
- 6 Flow switch
- 7 Climatic thermoregulation (outdoor probe as option)
- 8 Electronic board
- 9 IPX5D electrical protection
- 10 3-way valve
- 11 Circulation pump with anti-blocking function
- 12 Water pressure switch
- 13 Combustion chamber (burner, primary heat-exchanger, fan)

S.A.R.A. system: comfort and saving

CIAO S is equipped with the Beretta patented S.A.R.A. system (Automatic Temperature Control), which can be enabled by moving the temperature control knob of the central heating circuit to the “AUTO” sector (between 55°C and 65°C). The S.A.R.A. system achieves the best

compromise between the average temperature of the radiators and the quickness in reaching the required room temperature, while providing energy and money saving. When there is a demand for heating, the appliance will automatically raise the heating flow temperature twice by 5°C every 20

minutes, in order to heat the home more quickly. When the heating request has been satisfied (see diagram), the appliance will switch off automatically till the next heating request. At that point the boiler will start again at the previously set flow temperature.

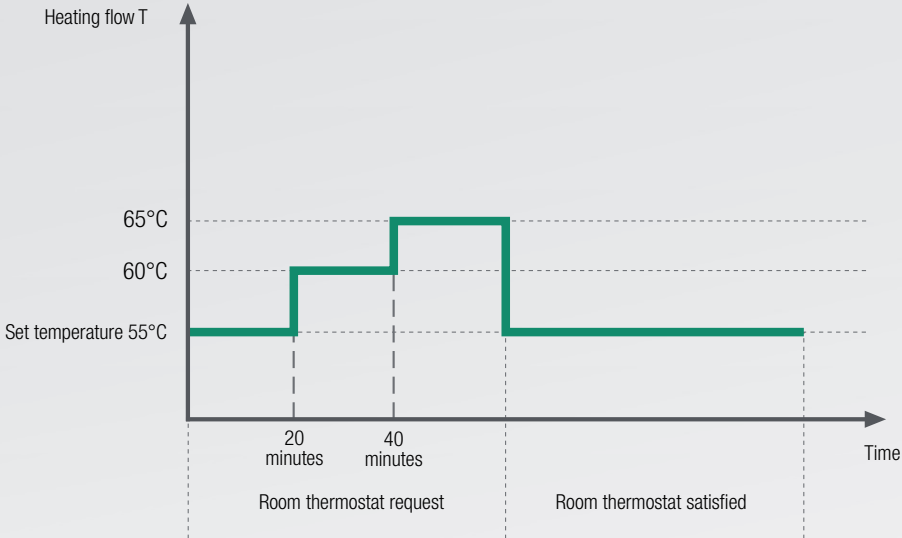

A room-sealed boiler for versatile installation

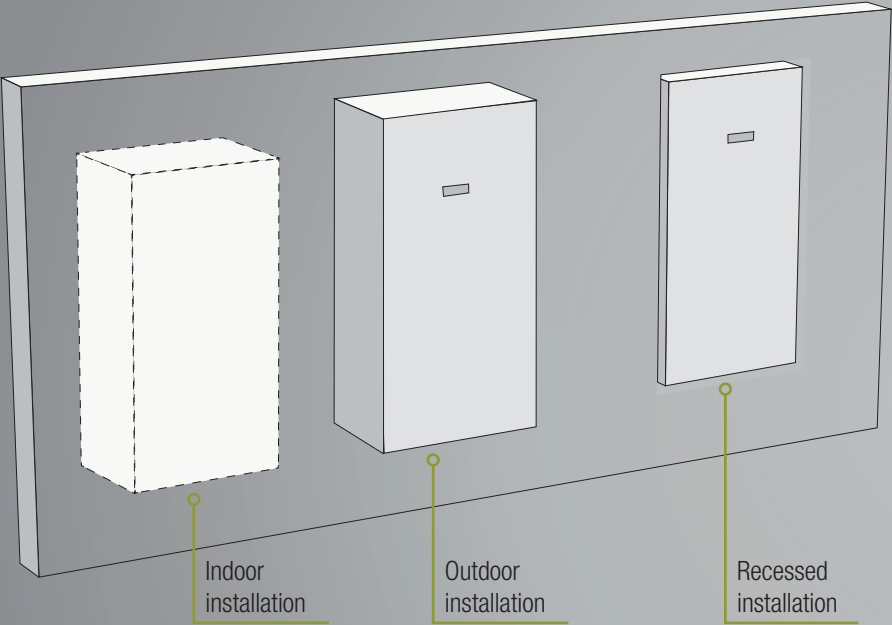

CIAO S has been specifically designed to be installed also outdoor in partially protected or recessed places, thanks to the specific accessories and the frost protection kit down to -10°C (available as option). Upper and lower covers are also available as option for a higher protection of the appliance and an elegant installation. The new CIAO S comes with the high electric protection IPX5D.



Technical drawings

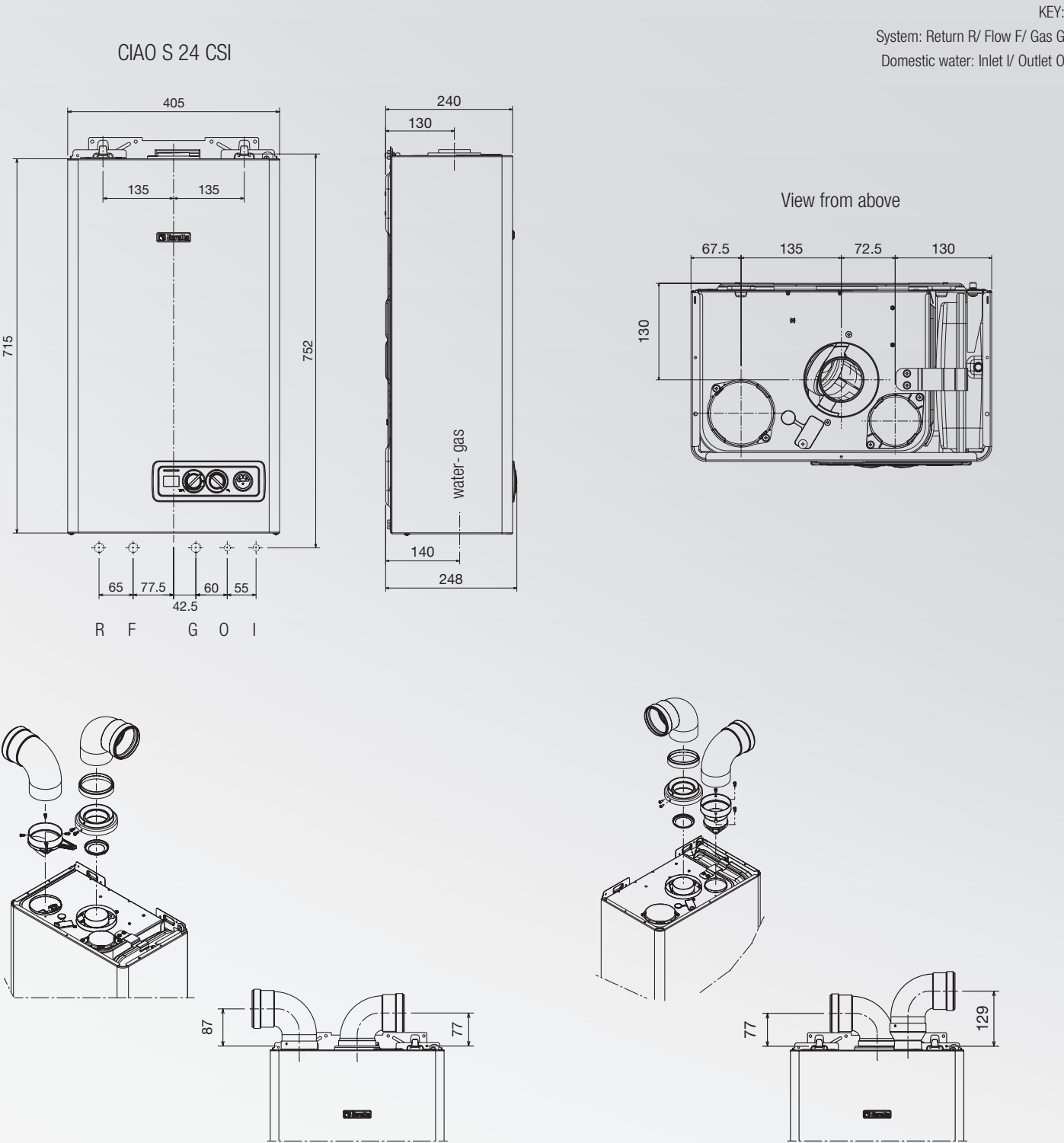

Technical data

C Combi model (CH + DHW) S Room-sealed I Ionisation flame control

SPECIFICATIONS AND MODELS

		CIAO S 24 C.S.I.
CH nominal heat input	kW	25,80
CH maximum heat output (80°-60° C)	kW	23,94
CH minimum heat input	kW	8,90
CH minimum heat output (80°-60° C)	kW	7,61
DHW heat input	kW	25,80
DHW maximum heat output*	kW	23,94
DHW minimum heat input	kW	8,90
DHW minimum heat output*	kW	7,61
Efficiency nominal output (Pn max - Pn min)	%	92,8 - 85,5
Efficiency at partial load 30% (47°C return)	%	90,9
Max power consumption	W	116
Power supply	V/Hz	230/50
Electrical protection	IP	X5D
CENTRAL HEATING		
Maximum pressure - temperature	bar - °C	3 - 90
Minimum pressure for standard operation	bar	0,25÷0,45
Adjustable CH water temperature range	°C	40÷80
CH expansion vessel pre-charge/Capacity	bar/l	1/8
DHW		
Maximum - minimum pressure	bar	6 - 0,15
DHW production ΔT=25°C	l/min	13,7
Hot water minimum flow rate	l/min	2
Adjustable hot water temperature range	°C	37÷60
CONNECTIONS		
CH flow - return/Gas	Ø	3/4"
DHW inlet - outlet	Ø	1/2"
CONCENTRIC PIPES		
Diameter	mm	60 - 100
Maximum length	m	4,25
TWIN PIPES		
Diameter	mm	80+80
Maximum length	m	16+16
DIMENSIONS, WEIGTH, GAS		
Boiler dimensions (HxWxD)	mm	715x405x248
Net weight	kg	31
Available gas versions		NG, LPG

\* average among the different functioning conditions in DHW  
\*\* LPG version available with separate kit (option)

Beretta International Markets  
Trading address:  
Via Risorgimento 23/A - 23900 LECCO - ITALY  
Tel. +39-0341-277111 - fax +39-0341-277263  
info@berettaboilers.com  
www.berettaboilers.com

In order to improve its product, Beretta reserves the right to modify the characteristics and information shown in this manual at any time and without advance warning.  
This brochure, therefore, cannot be considered as contractually binding on third parties.



1003 EN 04/14

Ciao S

Standard-Efficiency Wall-Hung Boilers

Residential Heating

